

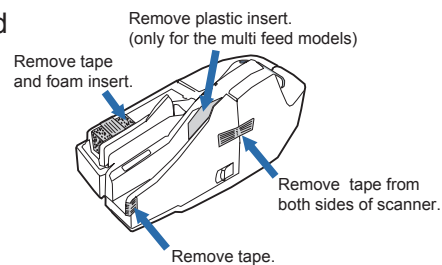

### 1 Unpack CaptureOne™.

1 Unpack CaptureOne™, and remove all the packing materials from unit.



2 Make sure you have all the parts shown here. If any parts are missing, contact your reseller.

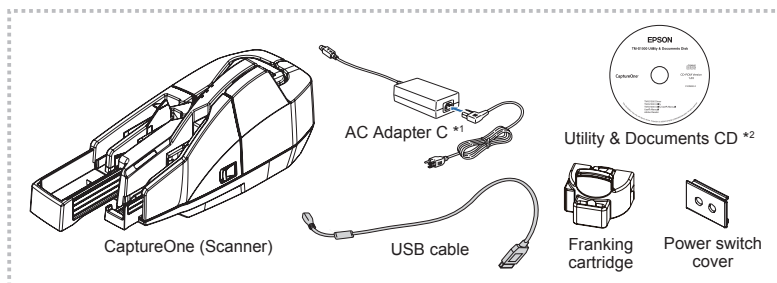

**Note:**

Do not open franking cartridge package until you are ready to install.

\*1: AC cable may not be included with the scanner.

\*2: The following items are included on the CD:

- TM-S1000 Driver
- TM-S1000 Utility
- TM-S1000 Utility User's Manual
- User's Manual (PDF in 4 languages: English, French, Portuguese, and Spanish)

3 Place on a stable, flat surface that extends beyond the scanner (with guides fully extended) in all directions.

**Note:**

Do not install scanner in a dusty environment. Do not install scanner where it can be subject to bumps or jolts during operation. These may cause defective readings.

#### Part Names

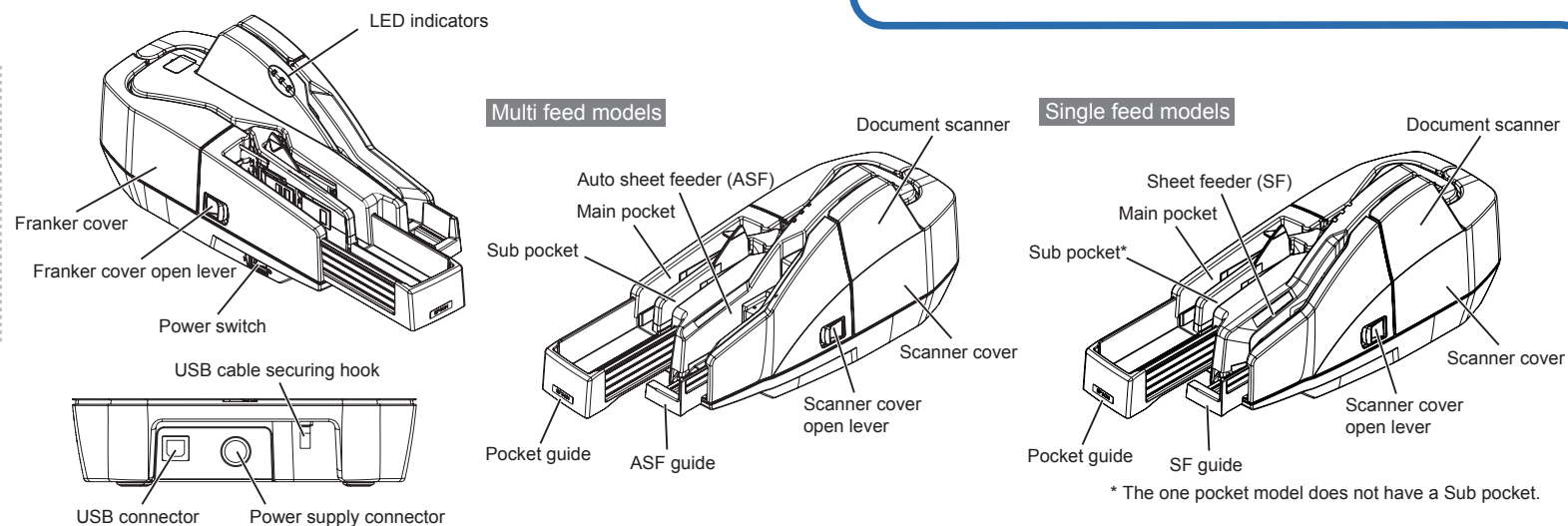

### 2 Pull out both pocket guide and ASF/SF guide.

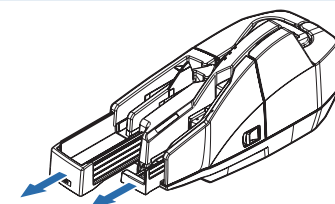

**Note:**

Be sure that the guides are extended completely before using.

### 3 Install the USB driver.

**CAUTION:**

Make sure that the power is not supplied to the scanner.

1 Start the TM-S1000 Utility included on the Utilities & Documents CD.

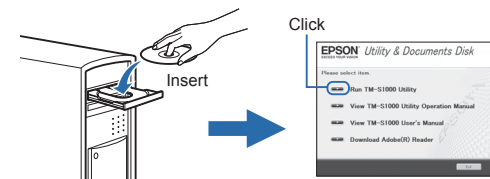

**CAUTION:**

Starting the TM-S1000 Utility causes the USB driver to be installed. Do not start the TM-S1000 Utility with the scanner connected to a host computer.

2 When the next screen is displayed, finish the TM-S1000 Utility.

### 4 Connect the USB cable to the scanner.

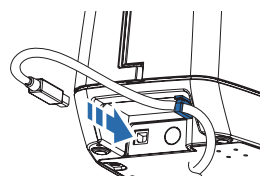

**Note:**

Use only the USB cable included with the scanner. Hook the USB cable on the USB cable securing hook (colored blue in the illustration) to prevent the cable from falling off.

### 5 Connect the DC cable to the scanner.

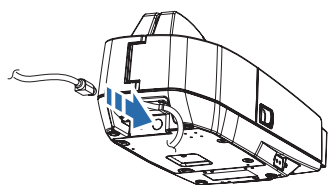

1 Make sure the power switch is turned off and the AC cable is not connected to the AC outlet.

**Note:**

Always disconnect the AC cable from the AC power outlet before connecting/disconnecting the DC cable to/from the scanner.

2 Insert the connector of the DC cable into the power supply connector (stamped 24V).

3 Plug the AC cable into the AC outlet.

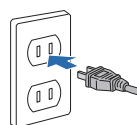

### 6 Connect the scanner to the computer via the USB cable.

**Note:**

If the scanner is connected to a host computer before installing the USB driver, the Found New Hardware Wizard will be displayed. In that case, cancel the wizard and go back to Step 3 to install the USB driver.

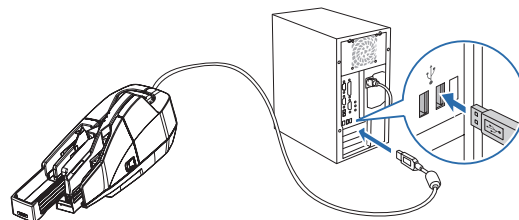

1 Connect the USB cable to the computer's USB port.

2 Turn on the scanner power switch.

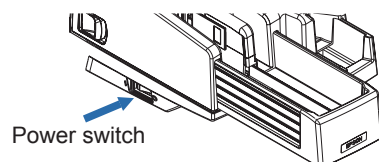

### 7 Install the franking cartridge.

**CAUTION:**

Keep franking cartridges out of reach of children. Use carefully because ink can permanently stain clothing. Use only Seiko Epson cartridges. Others may have poor quality or damage the scanner. Use up the cartridge before the expiration date printed on the box. Dispose of used cartridges in accordance with local regulations.

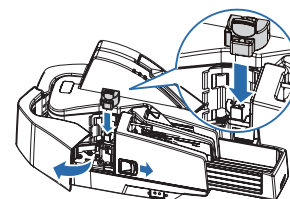

1 Pull the franker cover open lever to open the franker cover.

2 Hold the top of the cartridge, and carefully push it until it clicks into place.

### 8 Insert checks.

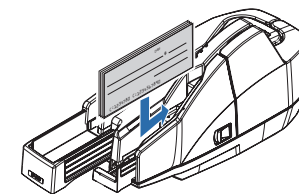

**CAUTION:**

For the multi feed models, if the checks are inserted without being aligned, they may not be fed at all, or a paper jam or incorrect feeding of multiple checks may occur. For the single feed models, if more than one check is inserted, a paper jam or incorrect feeding of multiple checks may occur. Be sure to let go of the check(s) before the scanner starts feeding. Do not open covers during processing.

**Note:**

Checks should not be wrinkled, torn, stapled, clipped or multi-sheet. For the multi feed models, up to 100 checks can be inserted in the ASF guide.

### 9 Remove ejected checks.

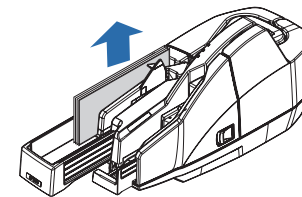

When checks are ejected, remove them.

**Note:**

Do not eject more than the maximum number of checks to the pockets. (Main Pocket: 100 sheets. Sub Pocket: 50 sheets.) Otherwise, a paper jam may occur. Depending on your application, some checks may be delivered to the sub pocket. (except for the one pocket model)

## LED Indicators

### POWER LED

Comes on when the scanner power is on.

### ERROR LED

- Comes on when the scanner is off line (and when the scanner cover or franker cover is open.)
- Flashes when an error occurs or when waiting for document removal. (See "Troubleshooting" for more information.)

### DOCUMENT LED

- Comes on when the scanner is ready to process documents in the ASF /SF or while the scanner is processing documents.
- Flashes when the scanner is waiting for document insertion.

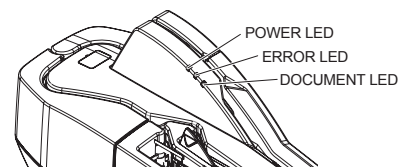

## Power Switch

Press the power switch to turn on or off the scanner.

### Power Switch Cover

#### WARNING:

If a machine failure has occurred while the included power switch cover is attached, unplug the power cable immediately. Continued use may result in a fire hazard.

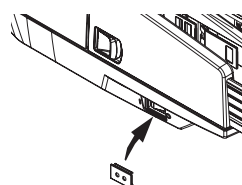

The power switch cover is intended to prevent the power switch from being pressed accidentally. To use the cover, place it over the power switch. When turning on or off of the switch is required, insert a pointed object into one of the holes of the cover, and press the switch.

When the scanner is stored or not in use for an extended period, turn off the power switch and disconnect the power cord.

## Cleaning

#### Note:

Clean scanner and MICR unit every six months or 100,000 passes. It is recommended to clean them once per week or once every 2,000 checks for good reading results.

Do not clean scanner with detergent, benzene, water, or other liquid. Never apply liquid directly to the scanner glass. Never use sticky cleaning sheets to clean MICR unit.

### 1 Cleaning the Image Scanner

Open scanner cover and lightly wipe the areas shown above with a soft, dry cloth. (If lens is smeared with grease, cloth can be moistened with alcohol.) Then, close scanner cover until it clicks into place.

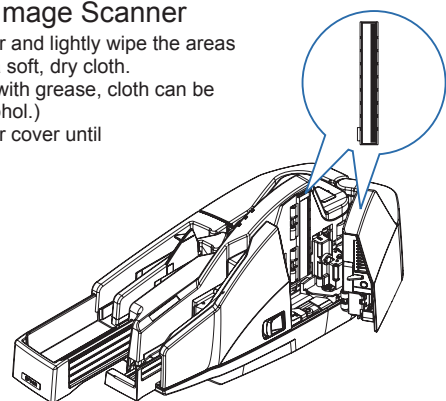

### 2 Cleaning the MICR Unit

- Use an approved Epson MICR cleaner card.
- Waffletechnology™ Check Scanner Cleaning Cards for Epson Check Scanners (part number KW2663-CS1B15WS EPSON CAPTURE ONE WAFFLE WS CLEANING CARDS 15/BOX).
- Use TM-S1000 Utility & Documents CD or your application for MICR cleaning.
- It is recommended to clean the image scanner after cleaning the MICR unit.

## Specifications

<b>Operating environment</b>	<b>CPU</b>	30/60 dpm models without using IQA or single feed models: Pentium 4 1.2 GHz or more Multi feed models using IQA or 90 dpm model without using IQA: Pentium 4 2.0 GHz or more
	<b>Memory</b>	30/60 dpm models without using IQA or single feed models: 256 MB or more above the minimum OS system requirements Multi feed models using IQA or 90 dpm model without using IQA: 512 MB or more above the minimum OS system requirements
	<b>HDD</b>	Free space of more than 30 MB (with the driver installed)
	<b>OS</b>	Microsoft Windows 2000 Service Pack 4 Microsoft Windows XP 32 Bit Service Pack 2/3 Microsoft Windows Vista 32 Bit Service Pack 1 Microsoft Windows Vista 64 Bit Service Pack 1
<b>Processing speed</b> (only for the multi feed models)		30 dpm, 60 dpm, or 90 dpm depending on the model.
<b>Image Scanner</b>		CIS (Contact Image Sensor)
<b>Resolution</b>		200 × 200 dpi, 120 × 120 dpi, 100 × 100 dpi
<b>Gradation</b>		256-level gray scale, 2 values (Black and White)
<b>Data format</b>		Gray scale: TIFF, JPEG, BMP, Raster Black and White: TIFF (CCITT Group4), BMP
<b>Scanning area (W × L)</b>		100* (*fixed) × max. 235 mm {3.94* (*fixed) × max. 9.25 in}
<b>Scanning speed</b>		500 mm/s {19.69 in/s}
<b>Paper</b>	<b>Type</b>	Normal paper (single-ply only)
	<b>Size (H × L)</b>	68 ~ 120 mm {2.68 ~ 4.72 in} × 120 ~ 235 mm {4.72 ~ 9.25 in}
	<b>Thickness</b>	0.075 ~ 0.2 mm {0.003 ~ 0.008 in} (single-ply only)
	<b>Weight</b>	60 ~ 120 g/m <sup>2</sup> {16 ~ 32 lb}
<b>ASF/SF paper supply</b>		ASF (for multi feed models): 100 sheets or fewer SF (for single feed models): one sheet
<b>Pocket storage</b>	<b>Main pocket</b>	100 sheets or fewer (when the paper thickness is 0.13 mm or less.) However, the total thickness must be 13 mm or less including warps.
	<b>Sub pocket</b> (except for the one pocket model)	50 sheets or fewer (when the paper thickness is 0.13 mm or less.) However, the total thickness must be 6.5 mm or less including warps.
<b>Franking cartridge</b>	<b>Type</b>	Exclusive franking cartridge (EFC-01)
	<b>Ink color</b>	Red
	<b>Life of ink</b>	18,000 times (based on Epson's standard pattern used for printing.)
<b>Power supply</b>		+24 V ± 10%
<b>Current consumption</b>	<b>Operating</b>	1.0 A
	<b>Standby</b>	0.2 A
<b>Interface</b>		USB 2.0
<b>Reliability</b>	<b>Life</b>	1,000,000 sheets
<b>Temperature</b>	<b>Operating</b>	10 ~ 40°C {50 to 104°F}
	<b>Storage</b>	When packed: -20 ~ 60°C {-4 to 140°F} (within 120 hours at -20°C {-4°F} or 60°C {140°F})
<b>Humidity</b>	<b>Operating</b>	20 ~ 80% (non-condensing)
	<b>Storage</b>	5 ~ 85%
<b>Overall dimension (W × H × D)</b>		355 × 176 × 160 mm {14.0 × 6.93 × 6.30 in}
<b>Mass (approx.)</b>		Multi feed models: 4.0 kg {8.8 lb} Single feed models: 3.9 kg {8.6 lb}

dpm: documents per minute, dpi: dots per inch (25.4 mm)  
IQA (Image Quality Assurance): Conforms to the recommendations of FSTC (Financial Services Technology Consortium).

## Troubleshooting

### ERROR LED is Flashing or Lit

- Make sure that the covers are properly closed.
- If a paper jam has occurred, remove the jammed paper, referring to the next section "Paper Jams."
- Turn off the scanner, and then turn it on after a while. If the error persists, consult a qualified service person for repair.

### Paper Jams

Open the scanner cover or franker cover to remove the jammed paper.

## Important Safety Information

This section presents important information intended to ensure safe and effective use of this product. Read this section carefully and store it in an accessible location.

### Key to Symbols

The symbols in this manual are identified by their level of importance, as defined below. Read the following carefully before handling the product.

#### WARNING:

Warnings must be followed carefully to avoid serious bodily injury.

#### CAUTION:

Cautions must be observed to avoid minor injury to yourself or damage to your equipment.

### Safety Precautions

#### WARNING:

Shut down your equipment immediately if it produces smoke, a strange odor, or unusual noise. Continued use may lead to fire. Immediately unplug the equipment and contact your dealer or a Seiko Epson service center for advice.  
Never attempt to repair this product yourself. Improper repair work can be dangerous.  
Never disassemble or modify this product. Tampering with this product may result in injury or fire.  
Use the specified AC Adapter (Epson AC Adapter. C, Model: M235A) only. Be sure your power cable meets the relevant safety standards and includes a power-system ground terminal (PE terminal). Otherwise shock may result. Be sure to use the specified power source.  
Connection to an improper power source may cause fire.  
Do not allow foreign matter to fall into the equipment. Penetration by foreign objects may lead to fire.  
If water or other liquid spills into this equipment, do not continue to use it. Continued use may lead to fire. Unplug the power cord immediately and contact your dealer or a Seiko Epson service center for advice.  
Before moving the product, unplug it and unplug all cables connected to it. Do not use aerosol sprayers containing flammable gas inside or around this product. Doing so may cause fire.

**LED RADIATION**  
CLASS 1 LED PRODUCT  
Maximum output: 320 μW  
Emitted wavelength: 515-540nm (Green)  
Test Specification: IEC 60825-1 (2001)

#### CAUTION:

Do not connect cables in ways other than those mentioned in this manual. Different connections may cause equipment damage and burning.  
Be sure to set this equipment on a firm, stable, horizontal surface. Product may break or cause injury if it falls.  
Do not use in locations subject to high humidity or dust levels. Excessive humidity and dust may cause equipment damage or fire.  
Do not place heavy objects on top of this product. Never stand or lean on this product. Equipment may fall or collapse, causing breakage and possible injury.  
To ensure safety, unplug this product before leaving it unused for an extended period.

### Notes on Usage

- When using the scanner, do not open the covers.
- Protect the scanner from impact.
- Do not apply excessive force to the scanner case.
- Do not place food or beverages such as coffee on the scanner case.
- Do not change the settings of the DIP switch under the bottom cover.

### Notes on Installation

- Be sure that the scanner is installed horizontally.
- Do not install the scanner in a dusty place.
- Install the scanner away from magnetic devices.
- Cables or other foreign objects must not be caught on the scanner.

### Notes on Transportation

- Keep the scanner upright and horizontal during transportation.
- Ensure that the ASF/SF and pocket guides are fully inserted during transportation.

## EMC and Safety Standards Applied

### WARNING

The connection of a non-shielded interface cable to this scanner will invalidate the EMC standards of this device.  
You are cautioned that changes or modifications not expressly approved by Seiko Epson Corporation could void your authority to operate the equipment.

### CE Marking

The scanner conforms to the following Directives and Norms:  
Directive 2004/108/EC

EN 55022 Class B  
EN 55024  
IEC 61000-4-2  
IEC 61000-4-3  
IEC 61000-4-4  
IEC 61000-4-5  
IEC 61000-4-6  
IEC 61000-4-8  
IEC 61000-4-11

### FCC Compliance Statement For American Users

This equipment has been tested and found to comply with the limits for a Class A digital device, pursuant to Part 15 of the FCC Rules. These limits are designed to provide reasonable protection against harmful interference when the equipment is operated in a commercial environment.

This equipment generates, uses, and can radiate radio frequency energy and, if not installed and used in accordance with the instruction manual, may cause harmful interference to radio communications.

Operation of this equipment in a residential area is likely to cause harmful interference, in which case the user will be required to correct the interference at his own expense.

### For Canadian Users

This Class A digital apparatus complies with Canadian ICES-003.  
Cet appareil numérique de la classe A est conforme à la norme NMB-003 du Canada.

### Restriction of Use

When this product is used for applications requiring high reliability/safety such as transportation devices related to aviation, rail, marine, automotive etc.; disaster prevention devices; various safety devices etc.; or functional/precision devices etc., you should use this product only after giving consideration to including fail-safes and redundancies into your design to maintain safety and total system reliability. Because this product was not intended for use in applications requiring extremely high reliability/safety such as aerospace equipment, main communication equipment, nuclear power control equipment, or medical equipment related to direct medical care etc., please make your own judgment on this product's suitability after a full evaluation.

All rights reserved. No part of this publication may be reproduced, stored in a retrieval system, or transmitted in any form or by any means, electronic, mechanical, photocopying, recording, or otherwise, without the prior written permission of Seiko Epson Corporation. No patent liability is assumed with respect to the use of the information contained herein. While every precaution has been taken in the preparation of this publication, Seiko Epson Corporation assumes no responsibility for errors or omissions. Neither is any liability assumed for damages resulting from the use of the information contained herein.

Neither Seiko Epson Corporation nor its affiliates shall be liable to the purchaser of this product or third parties for damages, losses, costs, or expenses incurred by purchaser or third parties as a result of: accident, misuse, or abuse of this product or unauthorized modifications, repairs, or alterations to this product, or (excluding the U.S.) failure to strictly comply with Seiko Epson Corporation's operating and maintenance instructions. Seiko Epson Corporation shall not be liable against any damages or problems arising from the use of any options or any consumable products other than those designated as Original Epson Products or Epson Approved Products by Seiko Epson Corporation.

EPSON is a registered trademark of Seiko Epson Corporation in Japan and other countries/regions.

NOTICE: The contents of this manual are subject to change without notice. Copyright © 2009 by Seiko Epson Corporation, Nagano, Japan.